

Arterial Complete Streets Program

The Program Focus:

- Traffic Operations
- Mobility & Congestion
- Intersection Evaluation
- Safety Improvements



The Gateway Cities Strategic Transportation Plan (STP)

The purpose of the Gateway Cities Strategic Transportation Plan is to develop a unified, sub-regional multi-modal transportation improvement strategy that can be used to obtain funding for the GCCOG Cities.

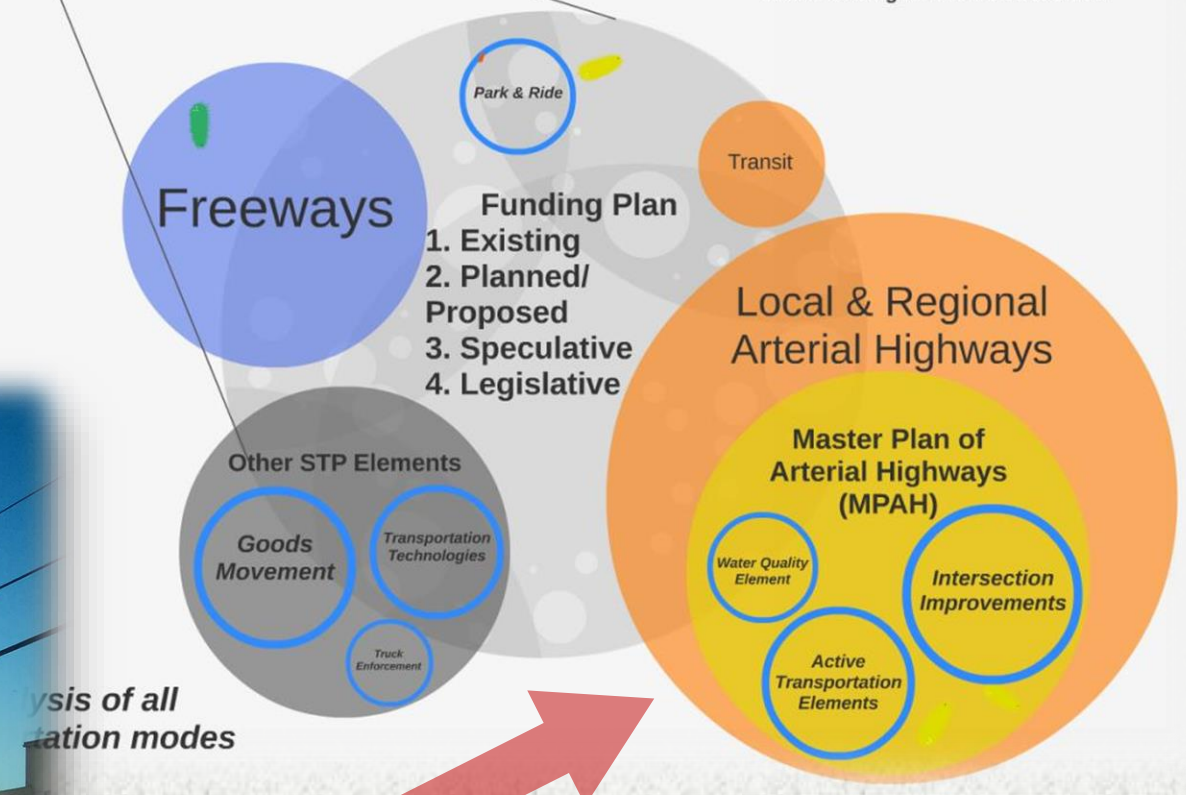

Top 25 - Major Arterial Corridors

Arterial Corridor Program Elements:

- Multiple Jurisdictions Regional Footprint
- Enhancing Mobility (all Modes)
- Traffic Calming
- Urban Greening & Enhancement
- Sustainability Planning
- Stormwater & Urban Runoff
- Economic Viability & Visioning
- Pedestrian Enhancement and ADA Compliance
- Median Improvement and Channelization
- Transit Operations
- Parking Enhancements

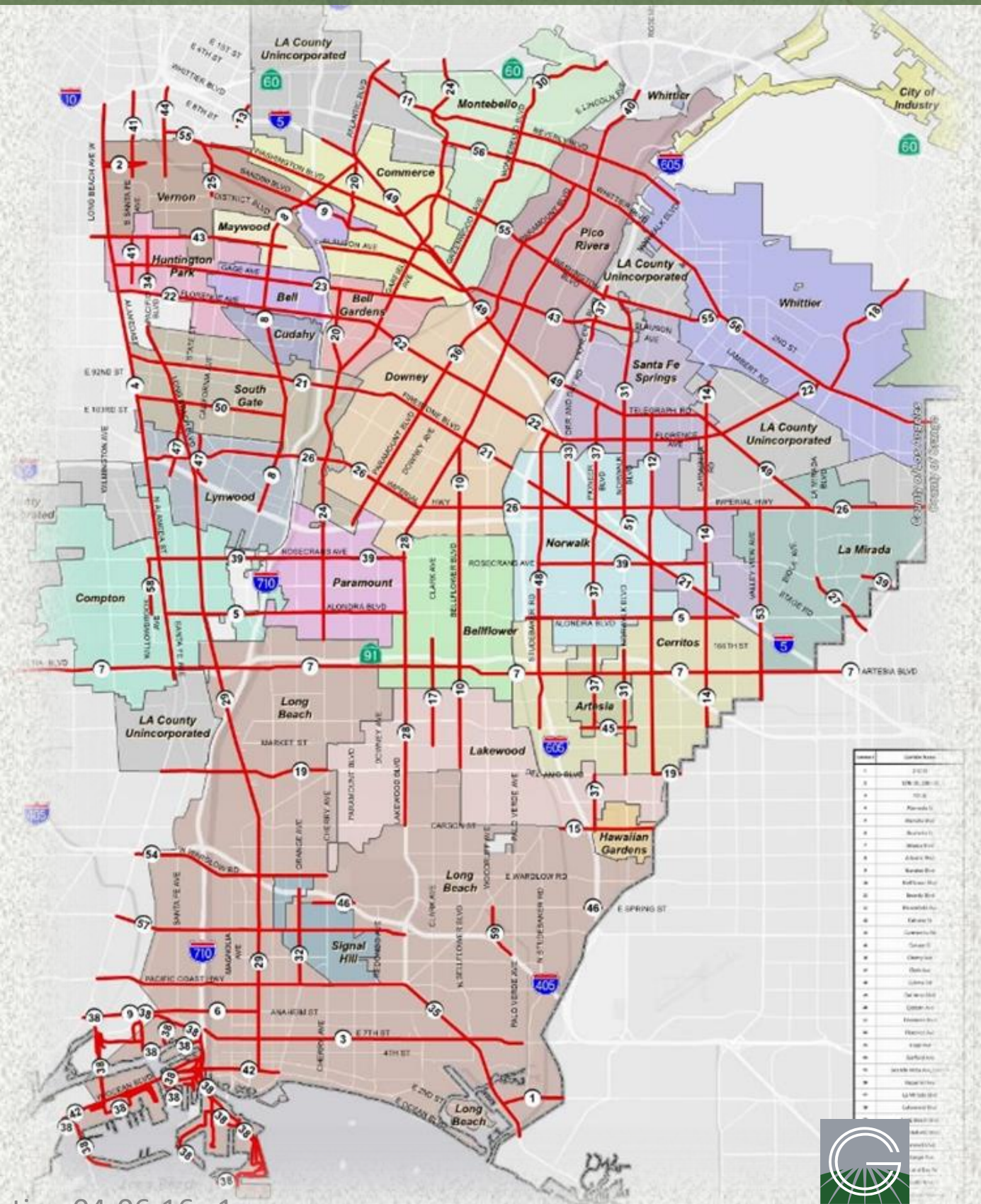

Intersection Hot Spots - Top 100 List

The Hot Spot Program:

- Intersection Evaluation
 - ✓ Top 100 – Traffic & Mobility
 - ✓ Congestion/Safety Improvements
- Connection to Arterial Street Master Plans

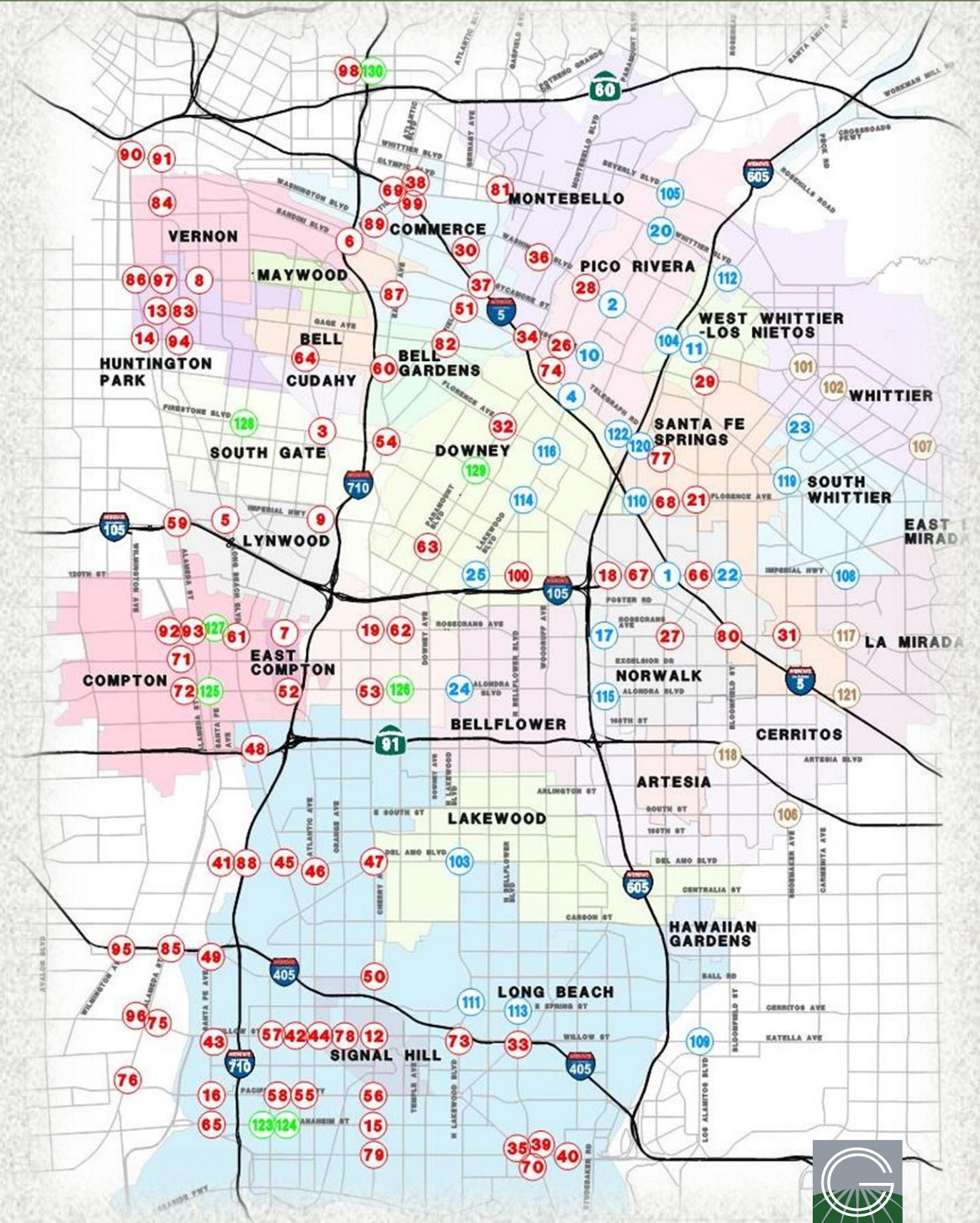

Arterial Streets - Livability Focus



- Connect & Activate Communities
- Parks & Open Space
- Active Transportation
- Watershed Planning



Conceptual Arterial - Urban Parks



Existing corridor with fenced off unmaintained open space



Transform the corridors with living active community elements...

Arterial Streets – Urban Planning

Transit Overlay

Selected Downtown Activity streets may need to accommodate public transit vehicles. Within the typical right-of-way, a wider streetside accommodates a bus shelter and related amenities adjacent to the vehicle stop area.

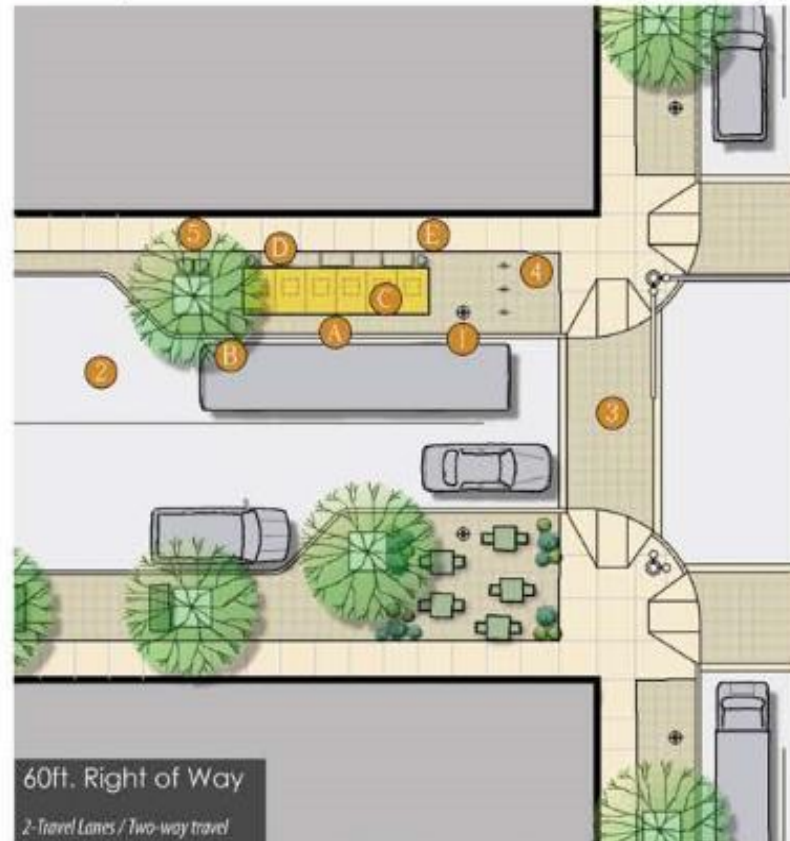

Plan Legend / VIA Req'd List

- A. VIA Transit Stop Shelter
- B. VIA Bus Sign
- C. Transit Seating Area
- D. Lean Rails @ Rear of Shelter
- E. Trash Receptacles

Other Potential Amenities

- 1. Street / Pedestrian Lighting
- 2. Street Trees
- 3. Enhanced Paving at Pedestrian Crossings
- 4. Bicycle Racks
- 5. Paper Vending Machine Screen



VIA Proposed Shelter
Designs still being refined



One-way Condition

Selected Downtown Activity streets have only one direction of travel. Within the typical right-of-way, three travel lanes can be accommodated, along with angled parking.

- Limited application to existing one-way streets.
- Potentially uses a reduction in travel lane(s) to add on street parallel or angled head in parking, landscaping, wider sidewalks and / or bicycle facilities.

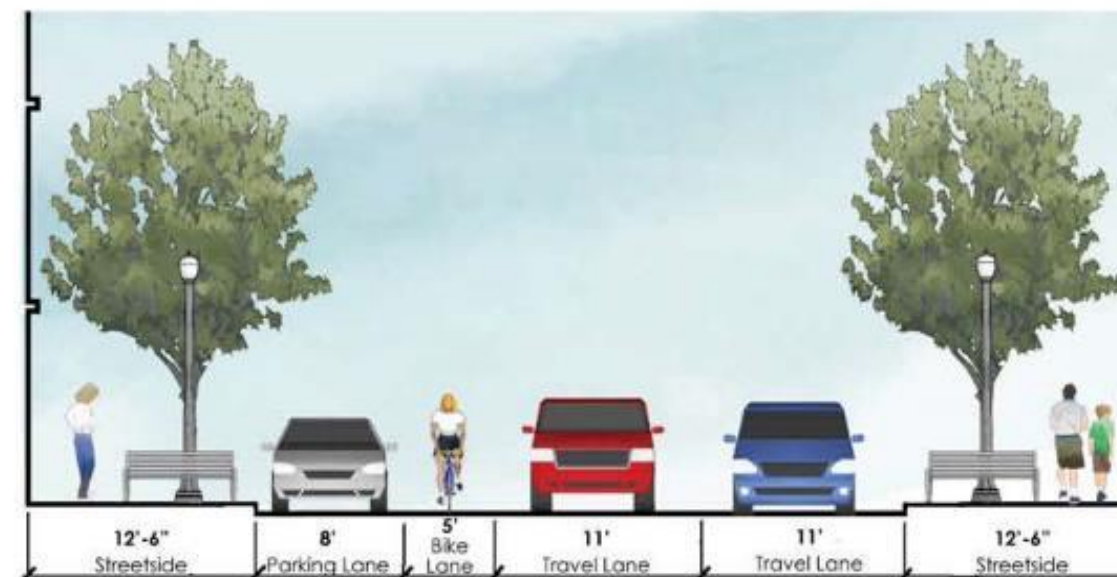
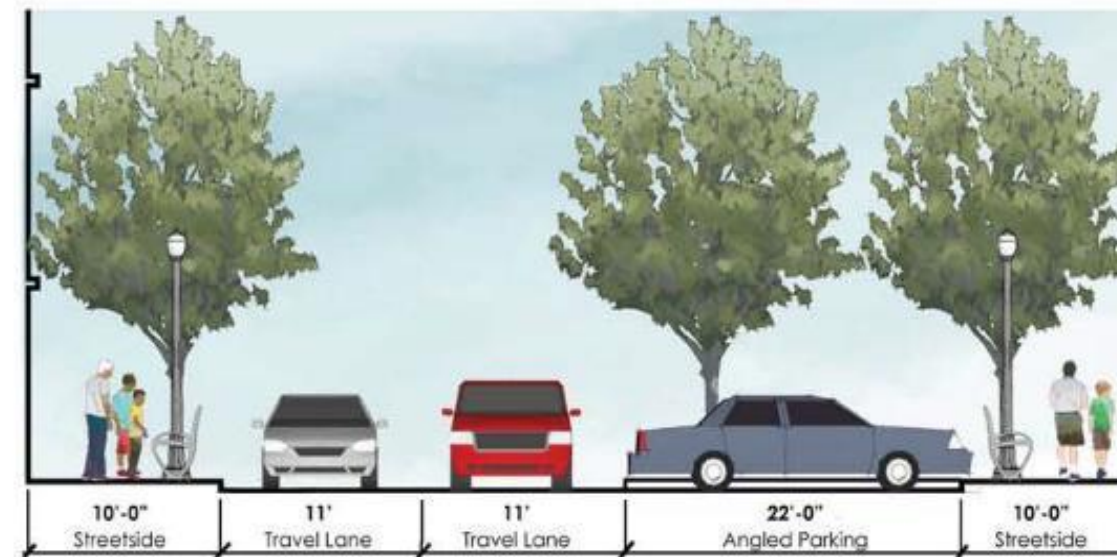

PRINCIPLE ARTERIAL (Section 1)

Characteristics of Principal Arterial Streets:

- Standard lanes
- Promote Bike Activity
- Promote Pedestrian Activity
- Mature Street Trees
- Transit Connections

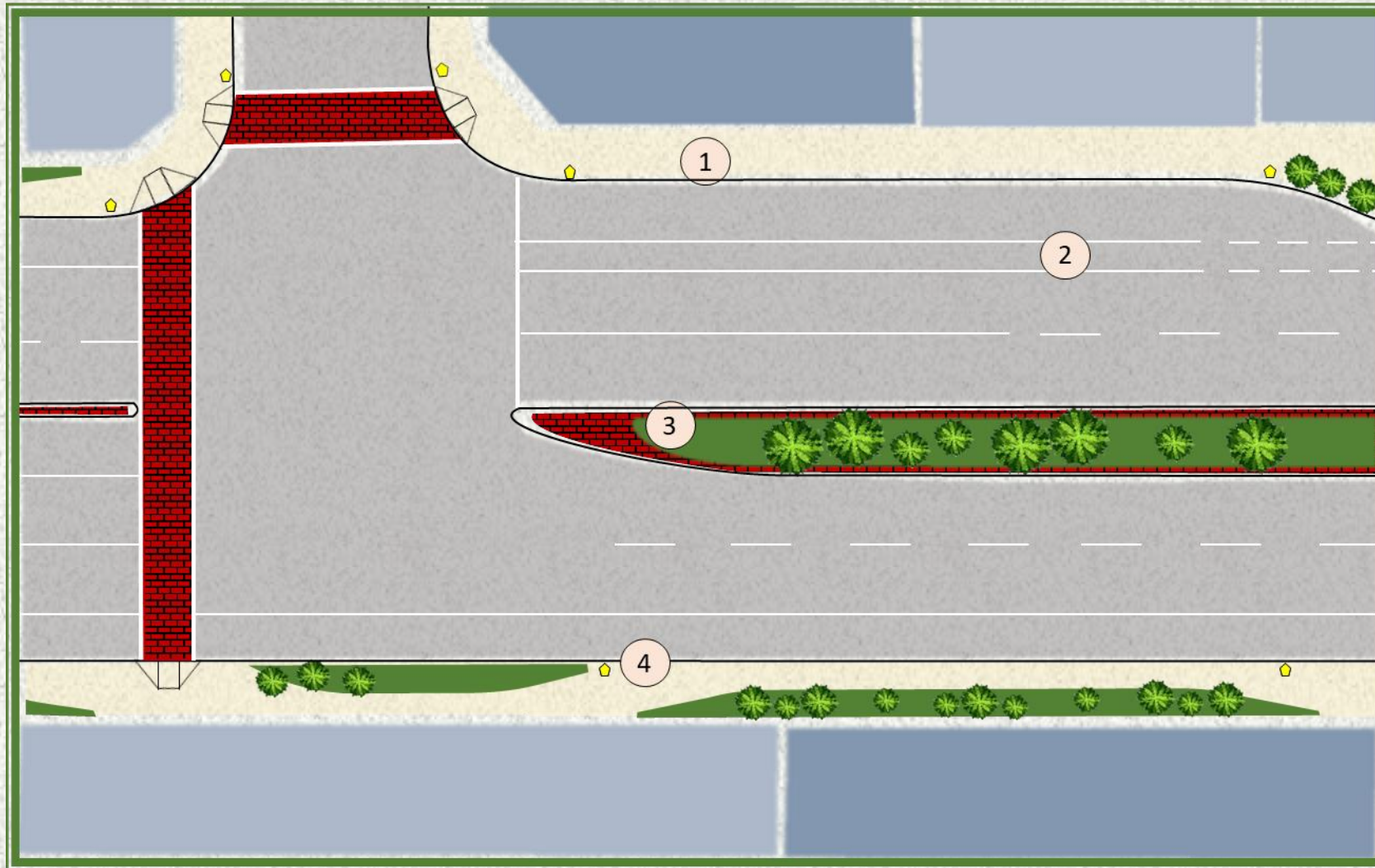

- 1 Meandering Walkway
- 2 Bike Lane
- 3 Landscape/Hardscape Medians
- 4 Decorative Street/Pedestrian Lighting

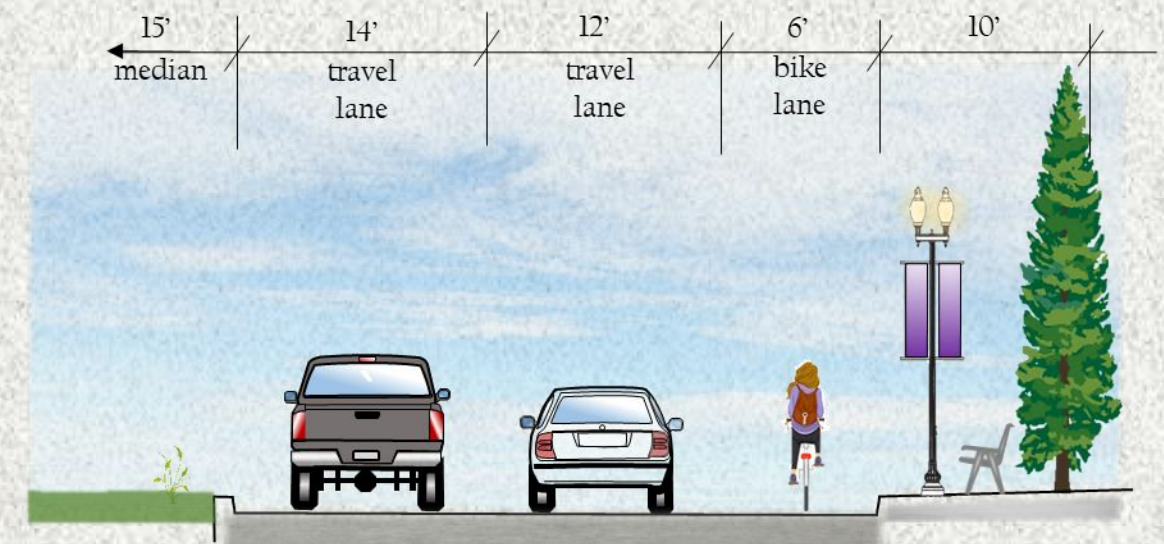

Principle Arterial
Roadway Half-Section

URBAN ACTIVITY (Section 2)

Characteristics of Urban Activity Streets:

- Promote Active Transportation
- Landscape Medians
- Defined Crosswalks
- Water Quality Features
- On-street Parking

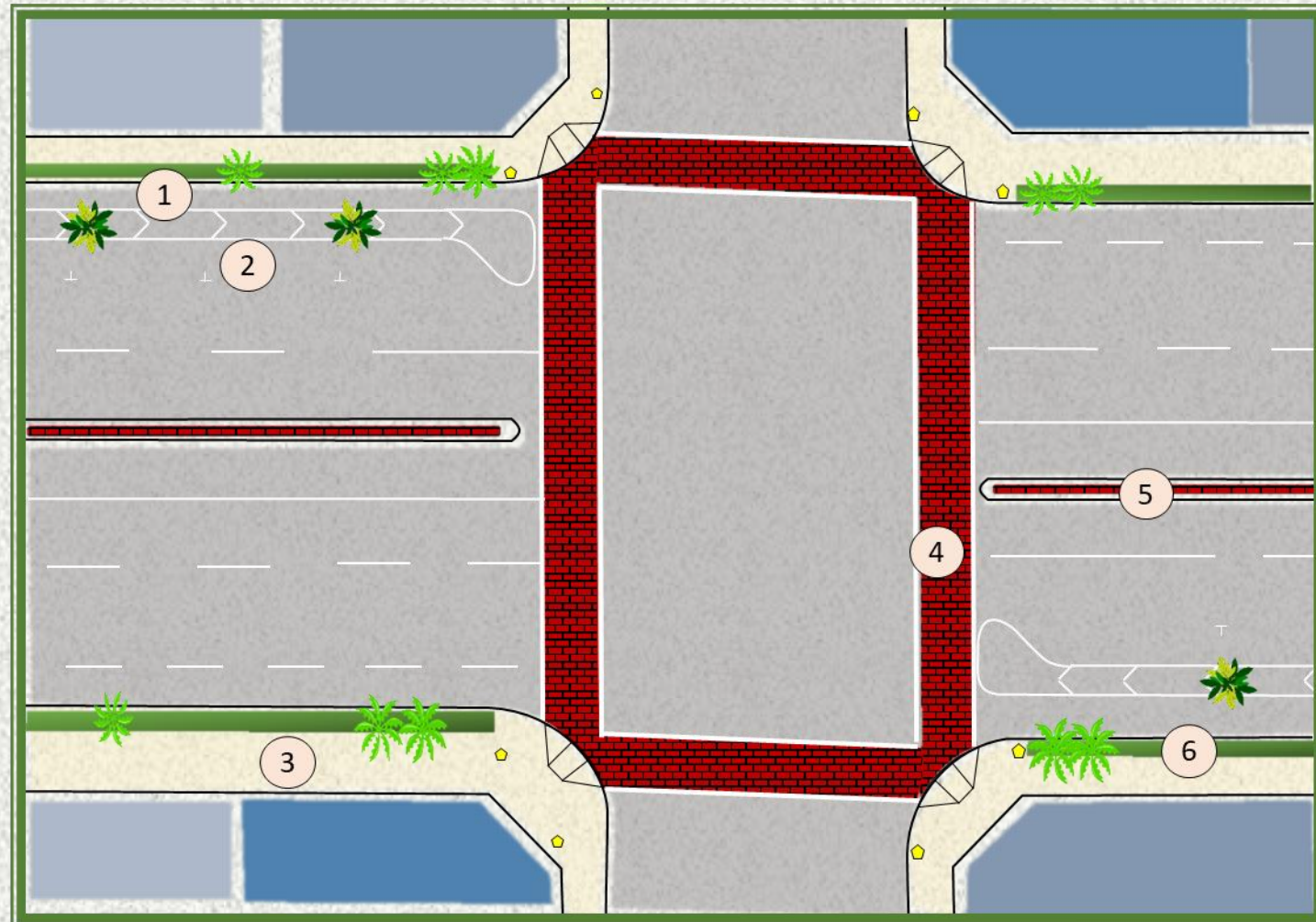

- 1 Bikeway
- 2 Street Parking
- 3 Walkway
- 4 Decorative Cross Walk
- 5 Landscaped Median
- 6 Bio-Swale

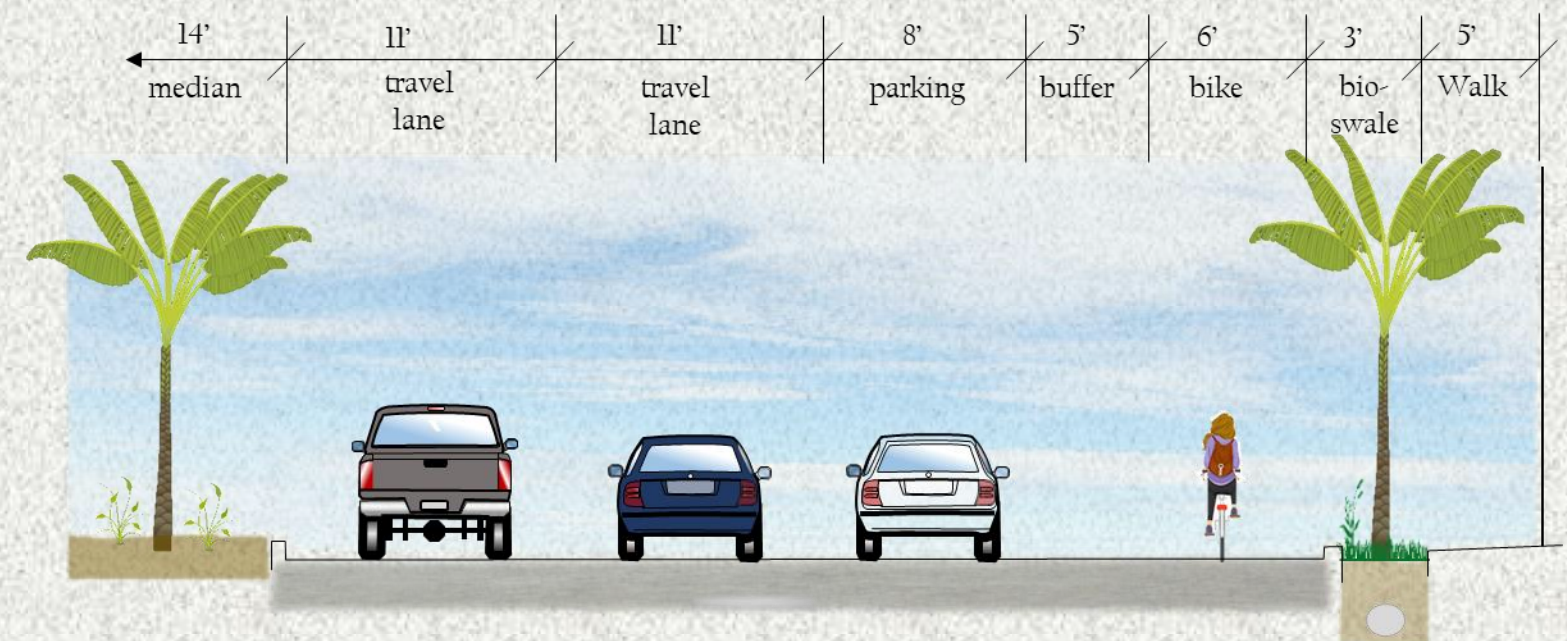

Urban Activity
Roadway Half-Section

RESIDENTIAL LIVING (Section 3)

Characteristics of Residential Living Streets:

- Narrower Lanes to Reduce Traffic Speeds
- Promote Bike Activity
- Promote Pedestrian Activity
- Mature Street Trees
- Soundwalls

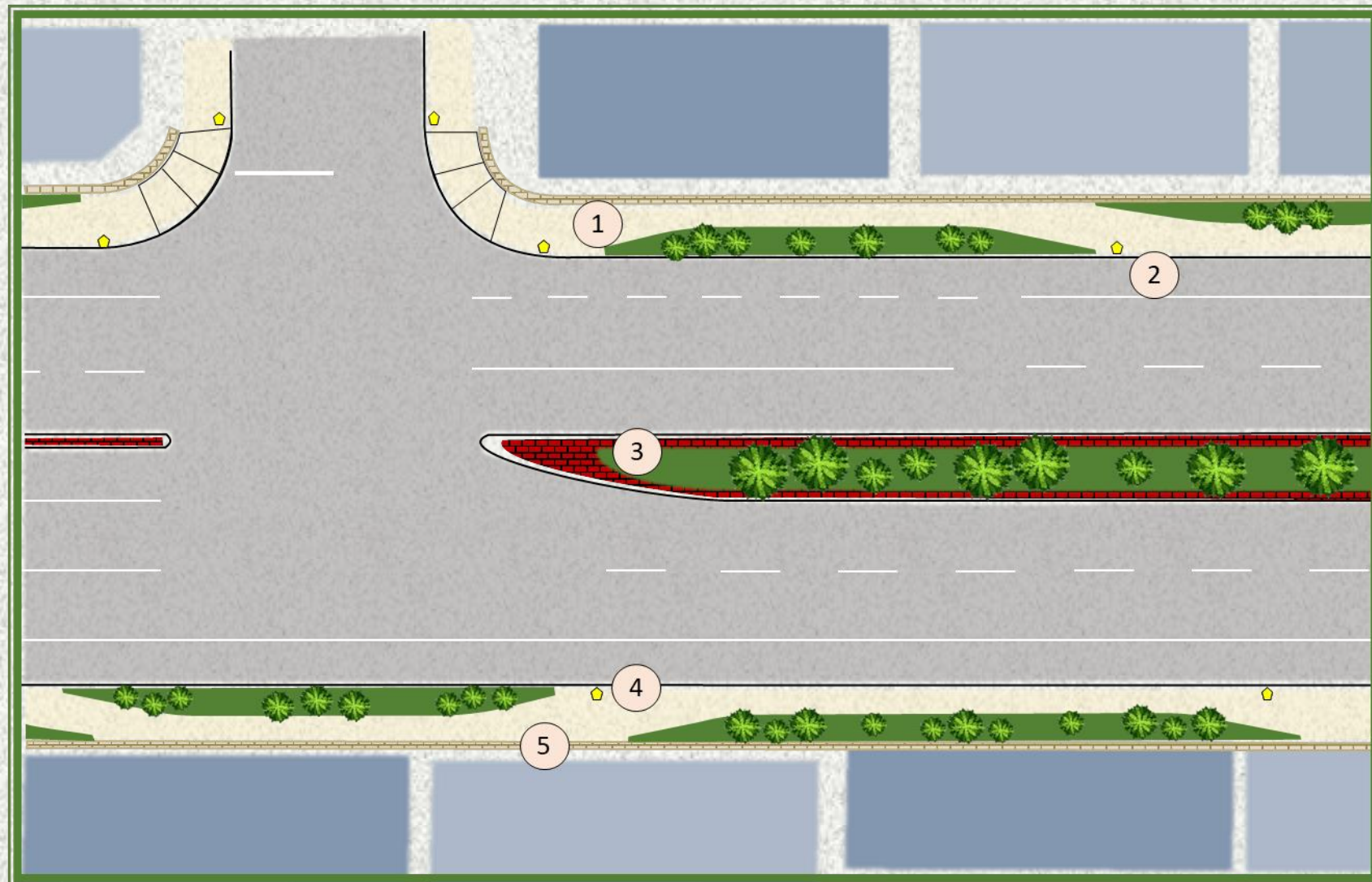

- 1 Meandering Walkway
- 2 Bike Lane
- 3 Landscape/Hardscape Medians
- 4 Decorative Street/Pedestrian Lighting
- 5 Soundwalls

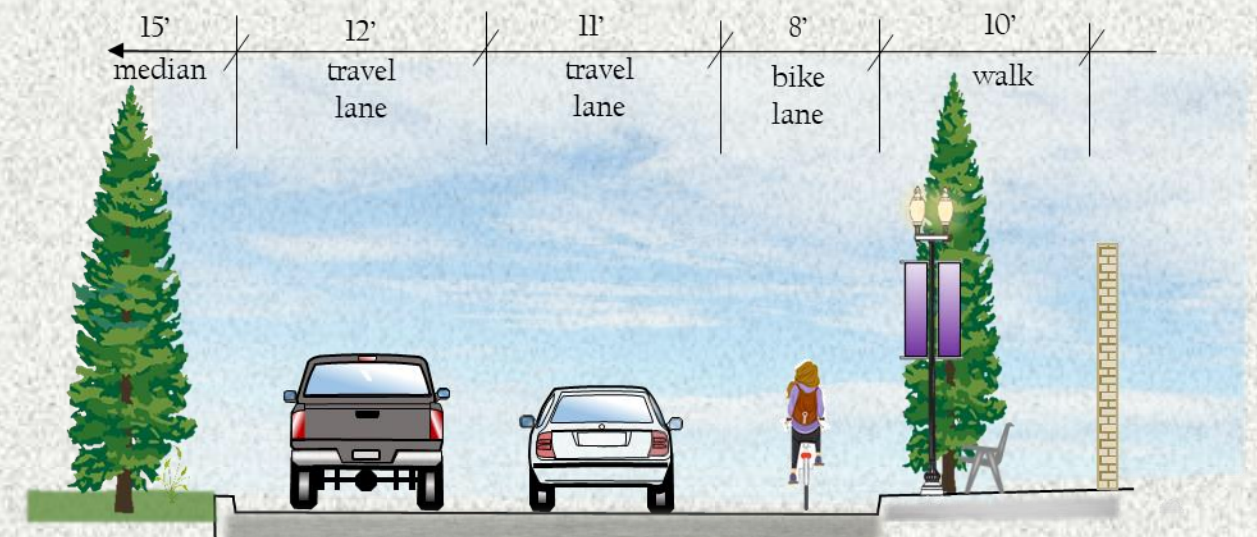

Residential Living
Roadway Half-Section

DOWNTOWN LIVING (Section 4)

Characteristics of Downtown Living Streets:

- Reduce Traffic Speeds
- Promote Pedestrian Activity
- Landscape Medians
- Mature Street Trees
- Special Districts
- Transit Connections



- 1 Street Tree
- 2 Landscaped Median
- 3 Decorative Cross Walk
- 4 Decorative Street/Pedestrian Lighting
- 5 Bus Stop with amenities
- 6 Streetscape Bike Racks

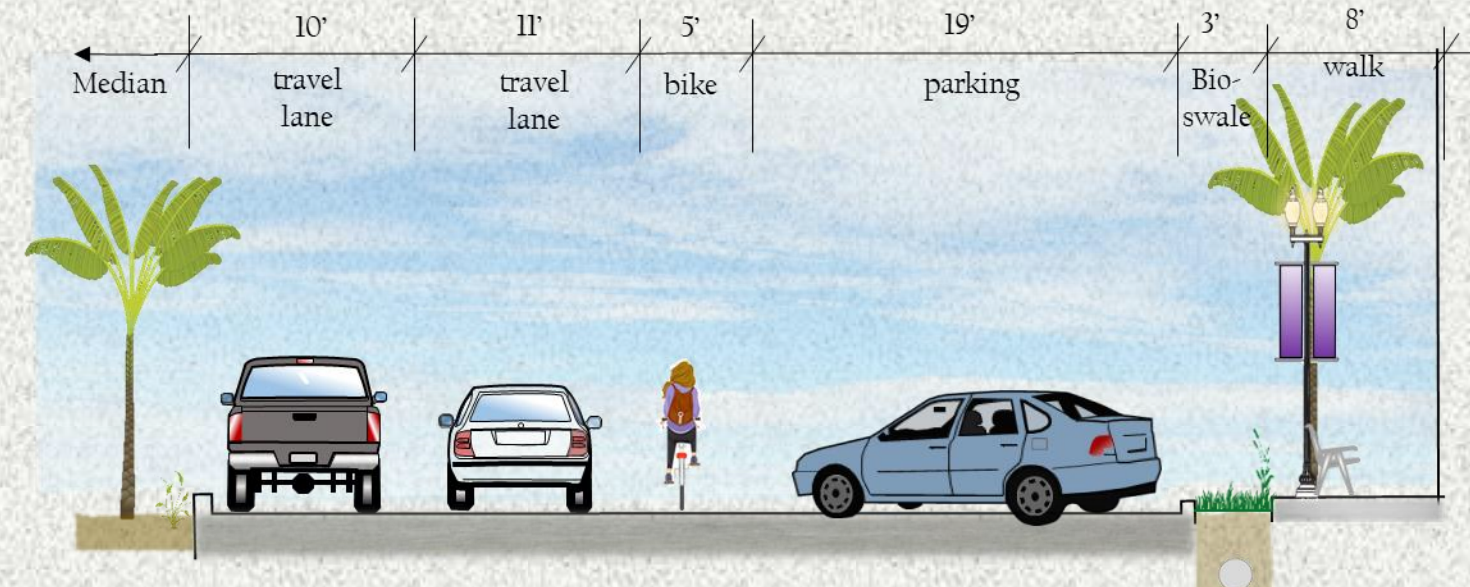

Downtown Living
Roadway Half-Section

2/6/2018

C: Drive Artesia Blvd - Street Designation 04-06-16 a1

ARTESIA BOULEVARD - Conceptual Planning Exhibits

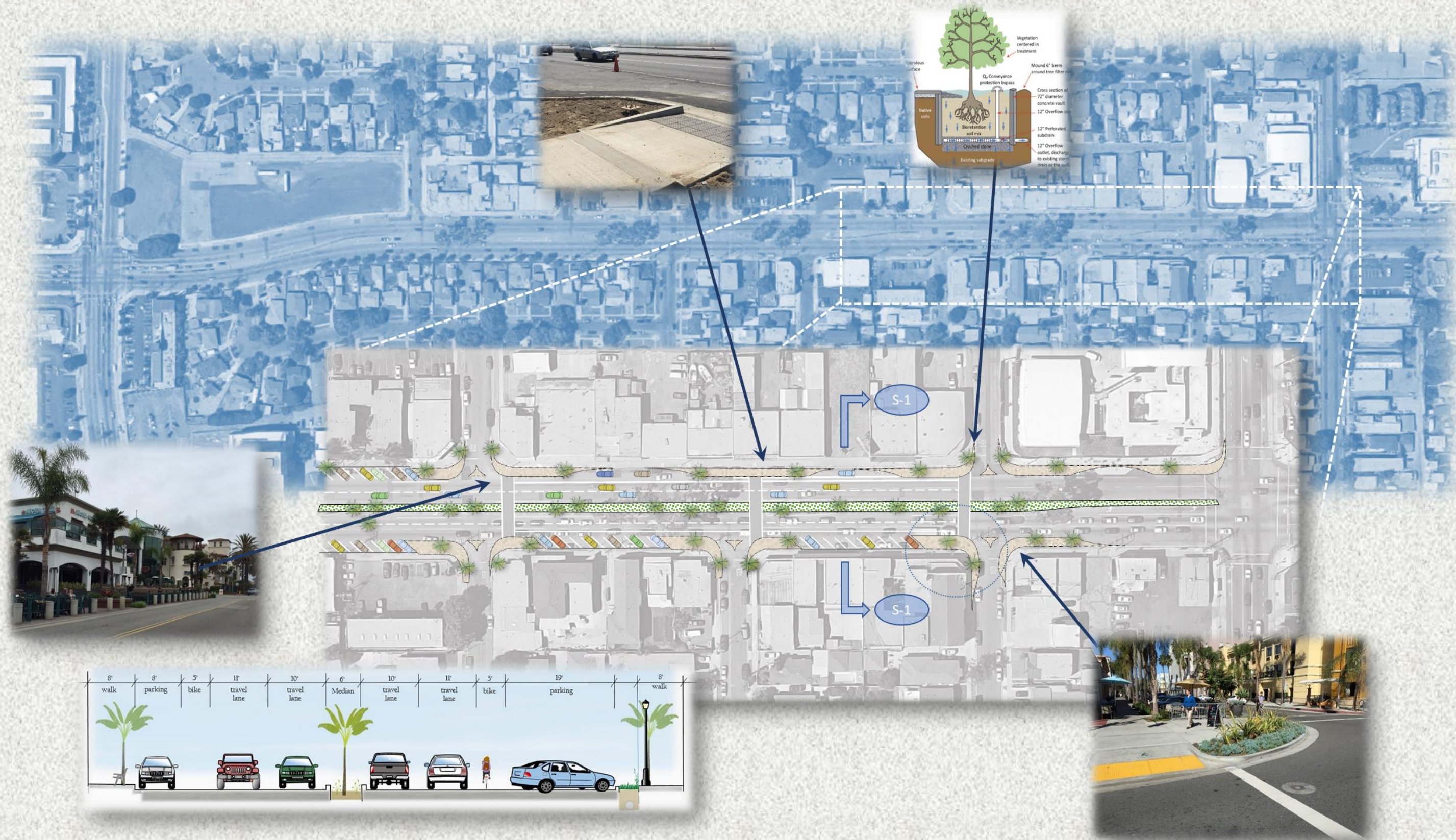

2/6/2018

C: Drive Artesia Blvd - Street Designation 04-06-16 a1

LAKEWOOD BOULEVARD – Conceptual Planning Exhibits

Existing Conditions



Sidewalk Parkway

- Improve Operations
- Reduce paved areas
- Activate parkways
- Enhance Aesthetics



ROSEMEAD BOULEVARD - Conceptual ATP Planning



**Constrained Pedestrian
Movements**



**Un-Constrained Pedestrian
& Bicycle Movements**

ROSEMEAD BOULEVARD - Conceptual ATP Planning



Existing Trail Conditions

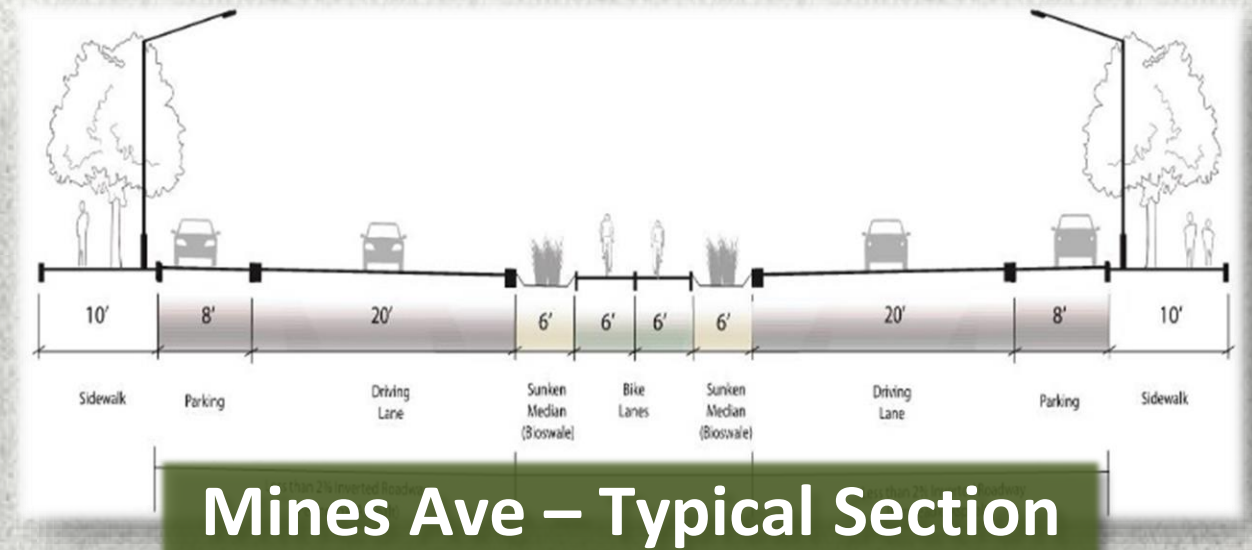

Urban Runoff & Stormwater Improvements



**Typical Existing
Catch Basin**



**Water Quality
Improvements**

2/6/2018

C: Drive Artesia Blvd - Stre



GATEWAY CITIES
COUNCIL OF GOVERNMENTS

Water Quality Planning

- ✓ Water Quality BMP's
- ✓ Urban Forest & Enhanced vegetation
- ✓ Enhanced Stormwater systems



Conceptual Planning Exhibits



Existing Conditions

Sidewalk Parkway



AESTHETICS, OPEN SPACE, and PUBLIC ART

Lighting



Fences/Railing



Structures



Public Art



Walls



Patterns/Textures



High Density & Transit Orientated Development



**Mixed-use,
compact
development**



Parking Evaluation & Planning



Sidewalk Parkway



VISIONING - Conceptual Urban Planning

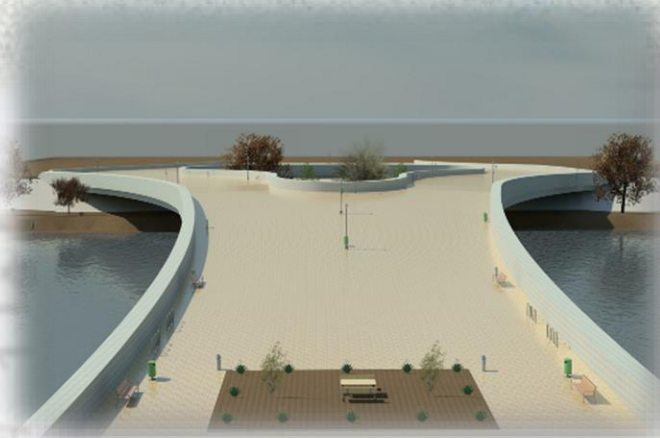

Arterial Complete Streets Visioning:

- ✓ Connects the Community
- ✓ Natural Resources
- ✓ Activate unutilized Space
- ✓ Create Living, Green, Connected Corridors



QUESTIONS & ANSWERS



Contact Information:

Kekoa Anderson, PE

Kekoa@KoaConsulting.net

(949) 887-0731